

PLAN SHOWING THE PROPOSED CONSTRUCTION OF STILL PARKING FLOOR+ 1st FLOOR OFFICE (COMMERCIAL) BUILDING AT MADHAVARAM-REDHILLS ROAD, MADHAVARAM, CHENNAI-600052 COMPRISED IN S.NO: 79 part, PRESENT S.NO : 79 / 2B2B (as per Doc.) and T.S.No : 79 / 2B2B (as per patta) OF LAYON GRANT VILLAGE WITHIN THE LIMIT OF PUZHAL PANCHAYAT UNION.

AREA STATEMENT (Sq.m)

AS PER DOC. : 485.62 Sq.m
AS PER FMB. : 400.00 Sq.m

FLOOR	FLOOR AREA in Sq.m	F.S.I AREA in Sq.m
STILT FLOOR	294.20	
FIRST FLOOR	322.70	322.70
SECOND FLOOR	171.00	171.00
TOTAL		493.70

SITE EXTENT

LEAST SITE AREA = 400.00 Sq.m
F.S.I ALLOWED = 2.00
PROPOSED F.S.I AREA = 493.70 Sq.m
F.S.I ACHIEVED = 493.70 / 400.00 = 1.234
PROVIDED CAR PARKING = 05 nos.
PROVIDED TWO WHEELER PARKING = 20 nos.

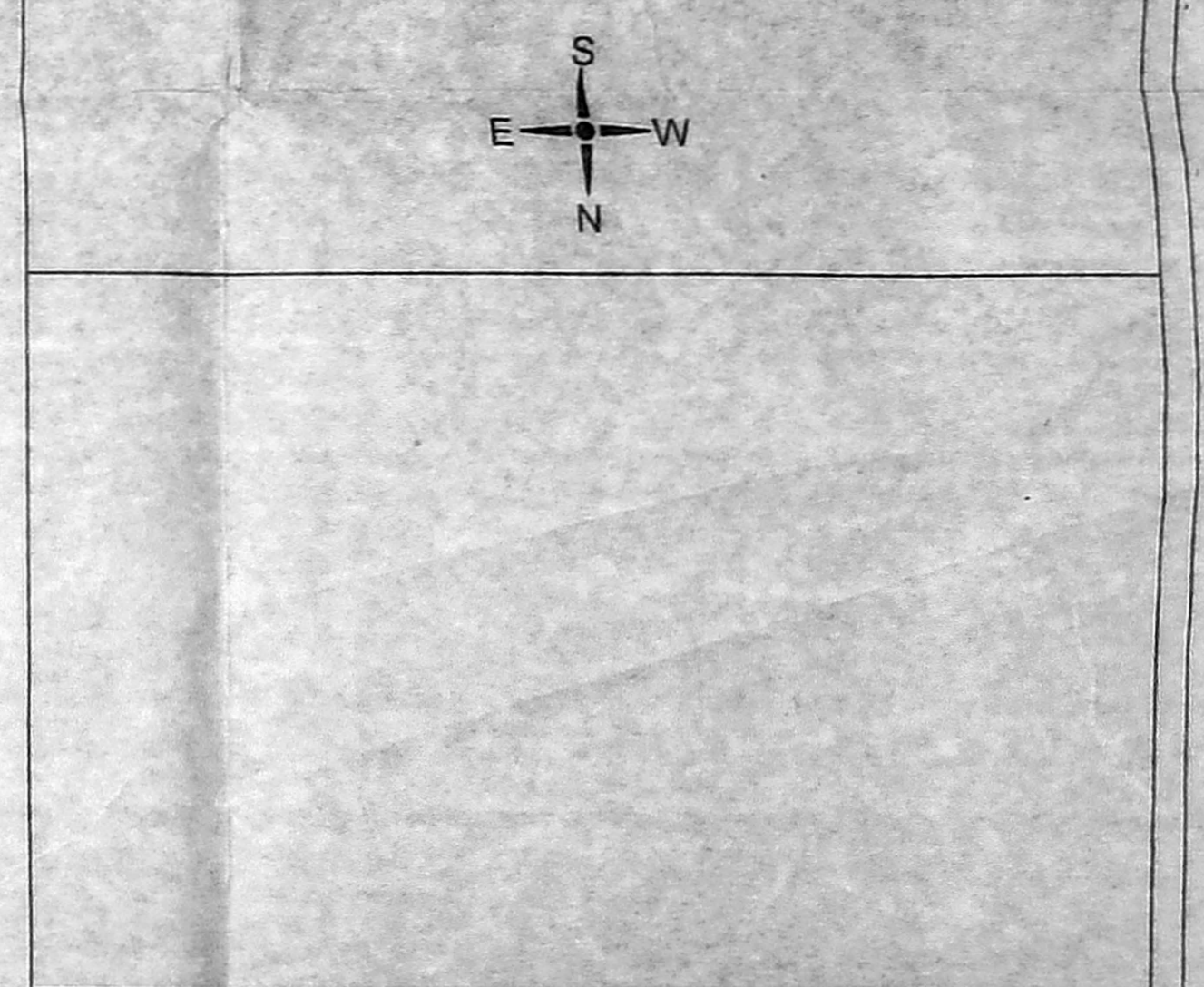
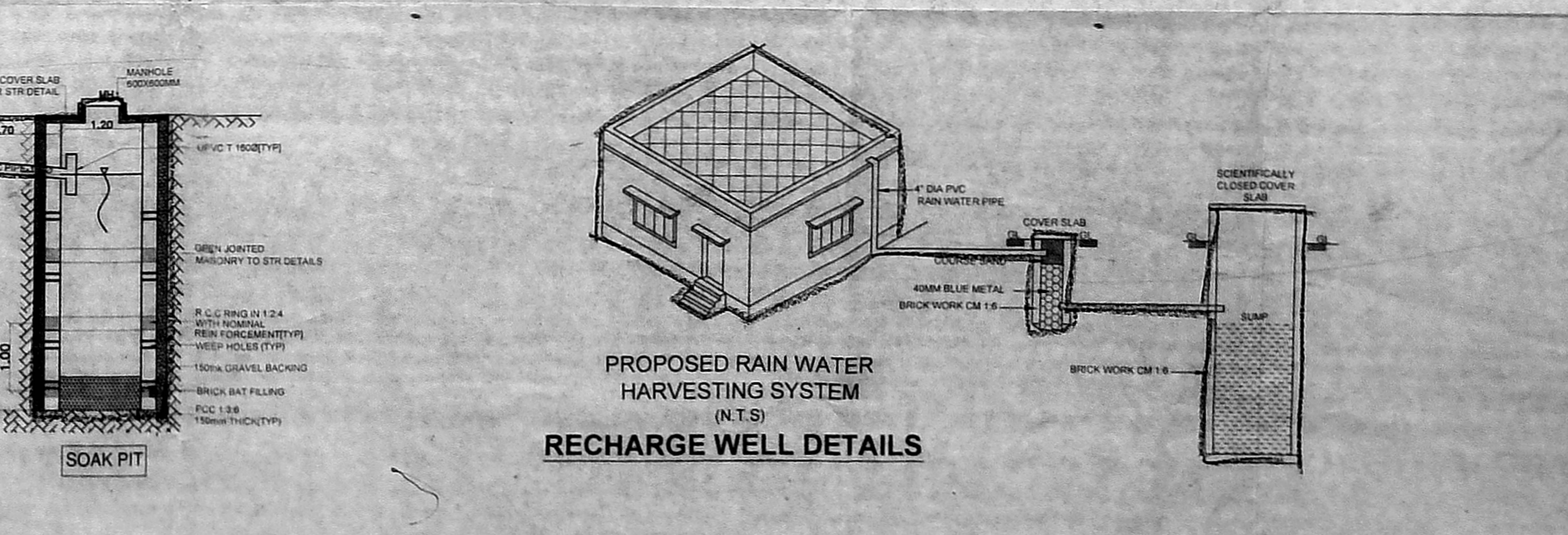
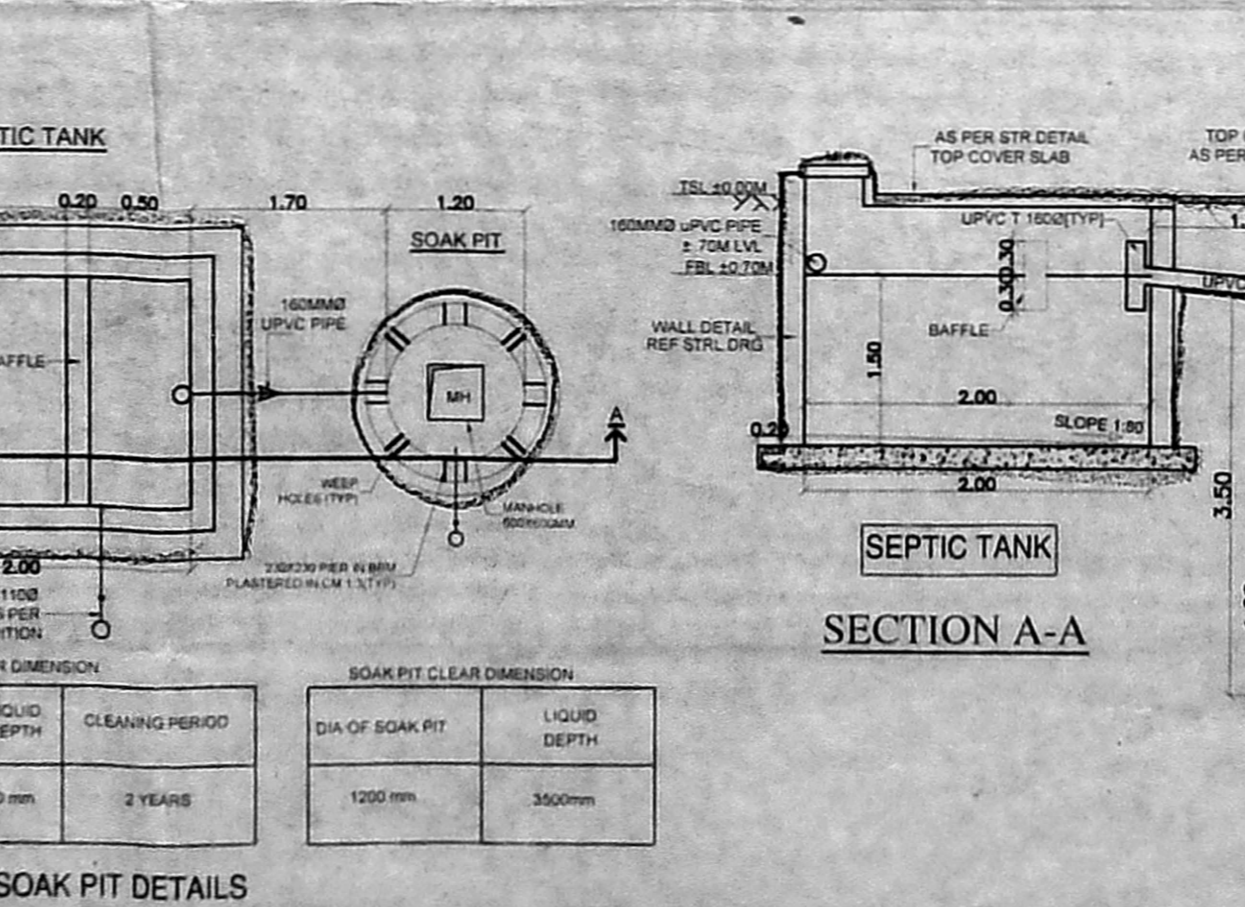
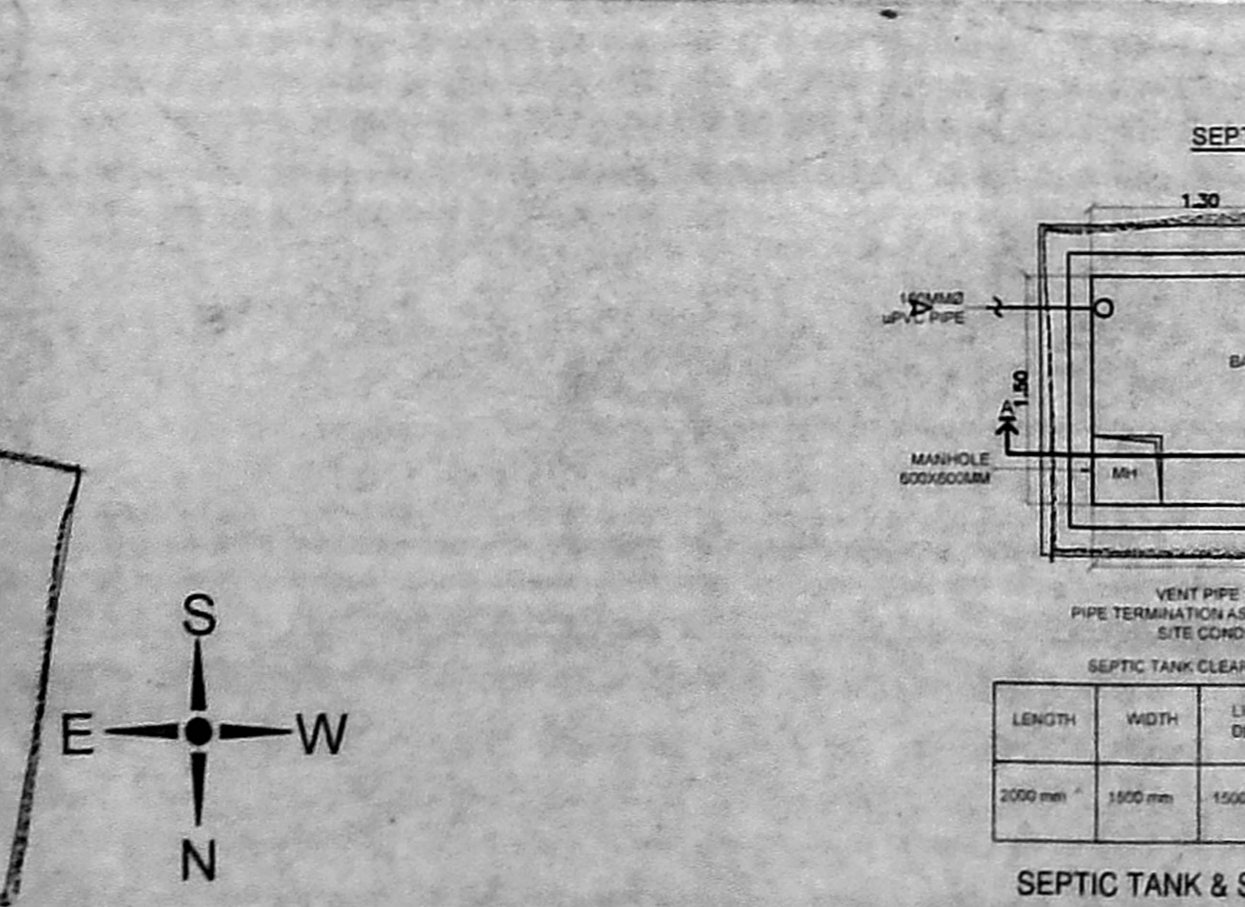
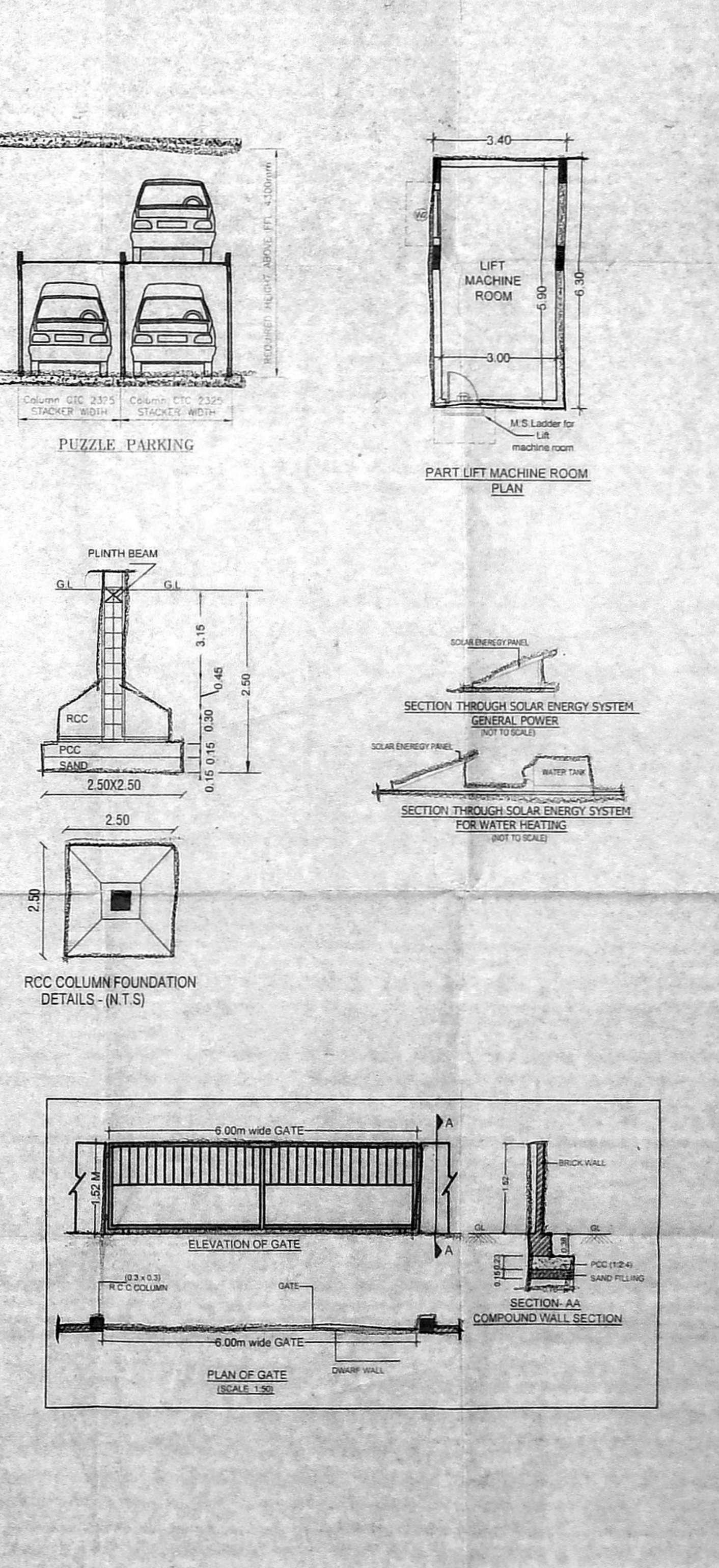
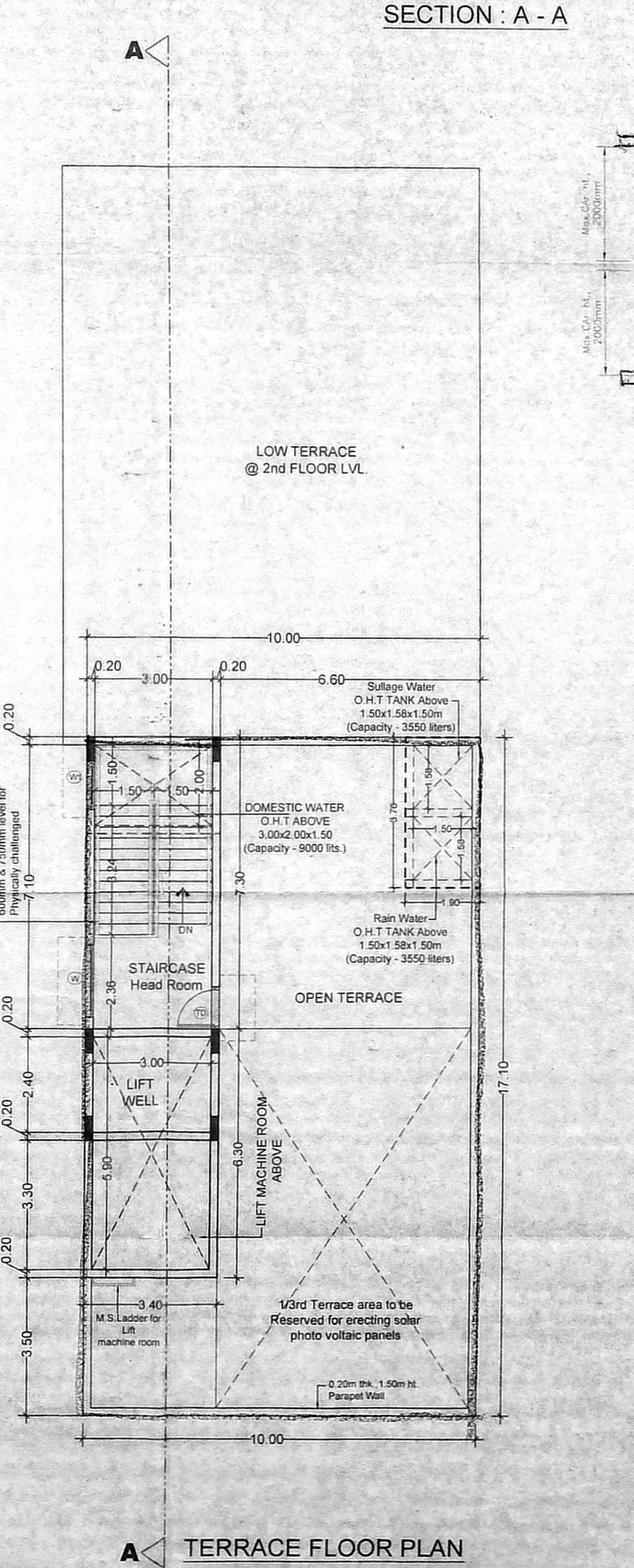
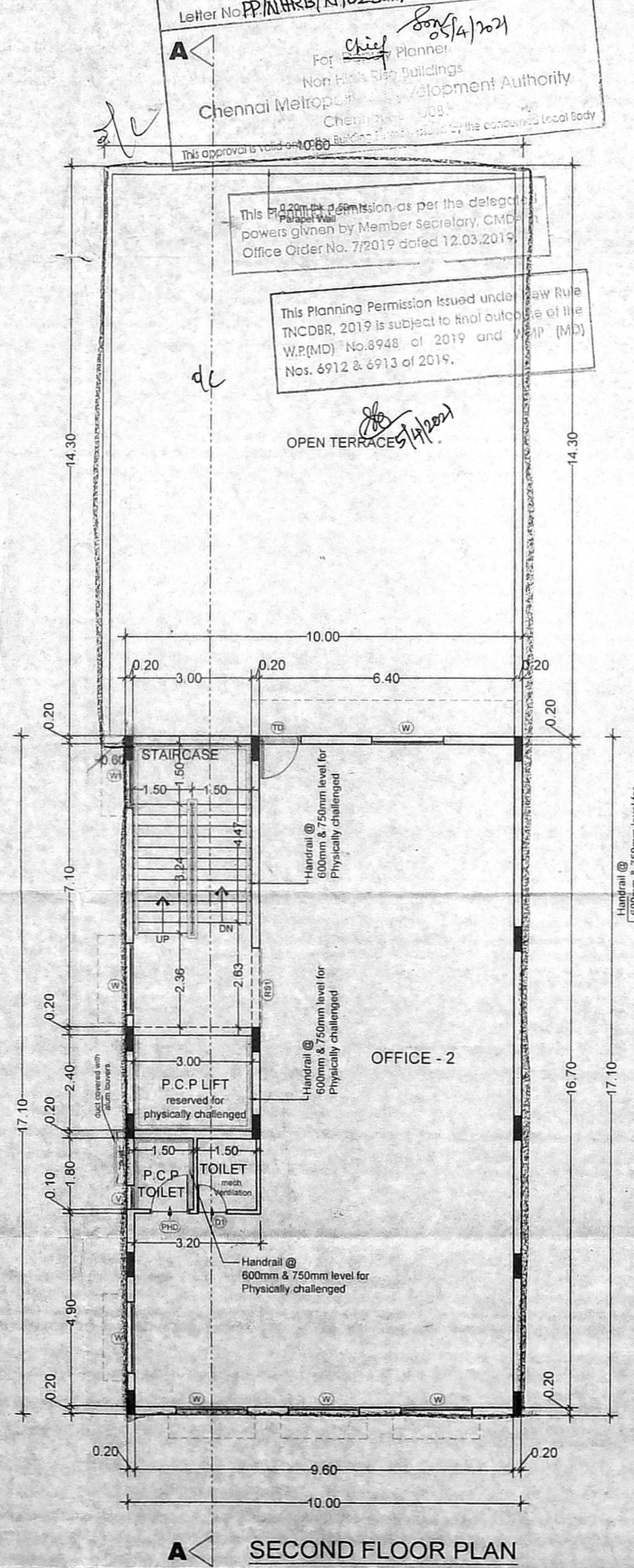
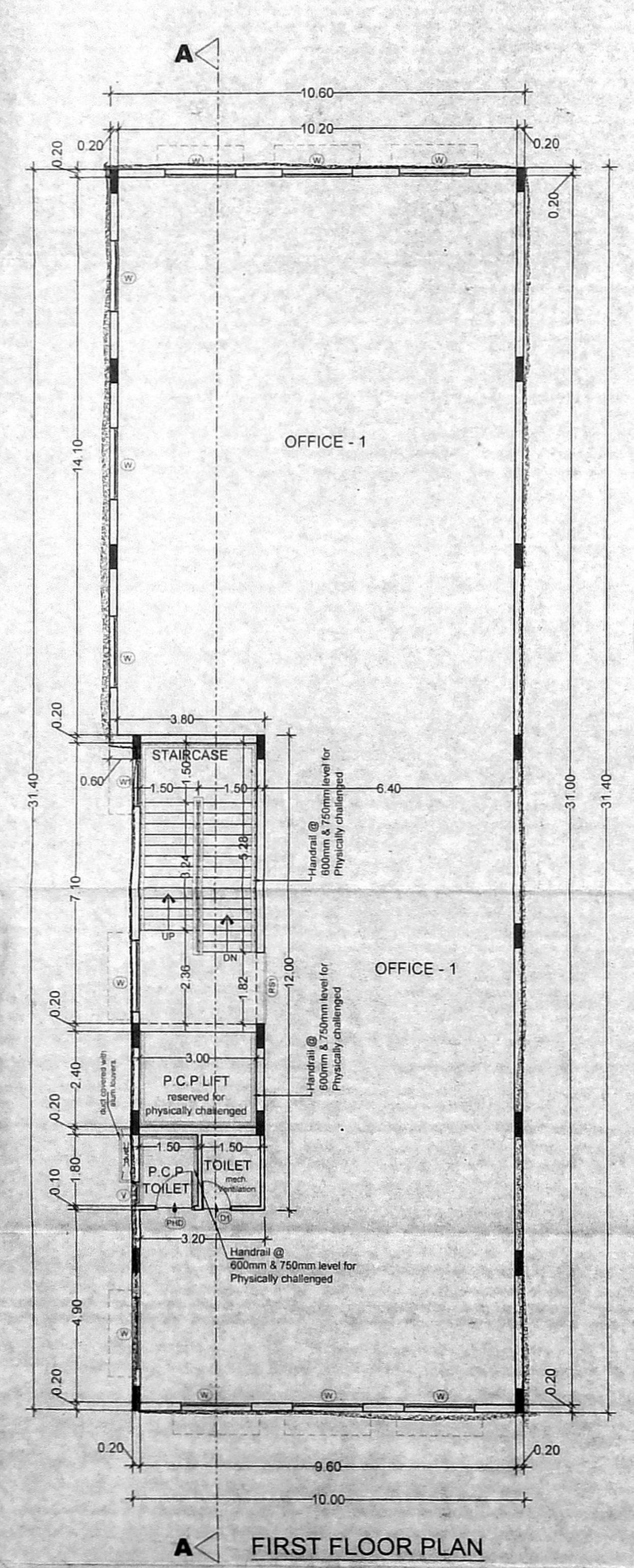
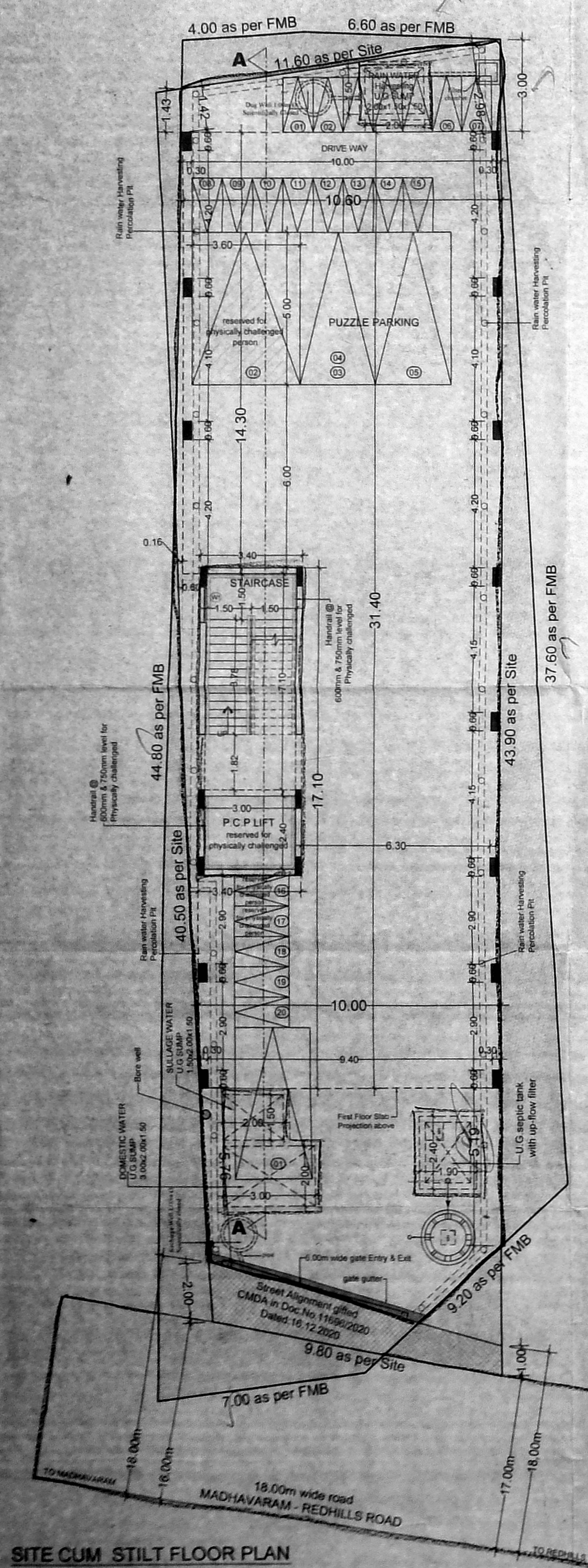

ALL DIMENSION ARE IN METER. SCALE: 1:100

SIGNATURE OF OWNER: *[Signature]*

SIGNATURE OF STRUCTURAL ENGINEER: *[Signature]*
C. KANNAN, B.E. M.E. Structural Engineer
CMDA Reg. No. SE/GR-116/02/002
Door No. 21, 4th Main Road, Indira Nagar, Chennai-600 020.

SIGNATURE OF ARCHITECT: *[Signature]*
VARSHA KANNAN (B. ARCH)
ARCHITECT & INTERIOR DESIGNER
REGD. NO. CA/95/18499
COUNCIL OF ARCHITECTURE
A.R. COMPLEX, FIRST FLOOR,
1050, P.H. ROAD, CHENNAI 600 084